



## Expand Your Clamping Options

Clamping Solutions for 70 bar applications

Shown: LUCD772



**▶ Link Clamp allows unobstructed part loading - extend to produce clamping force and retract to allow part removal.**

Arm completely retracts to allow part loading.

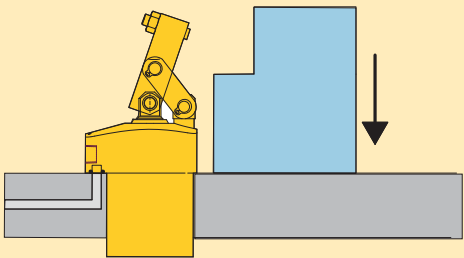

As cylinder extends, arm rotates to clamp part in place.

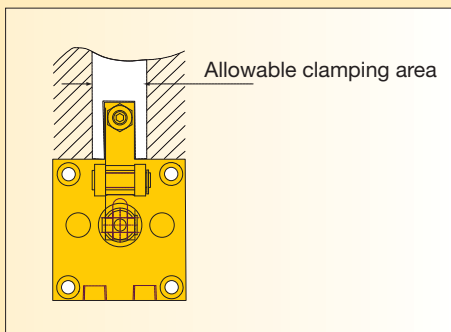
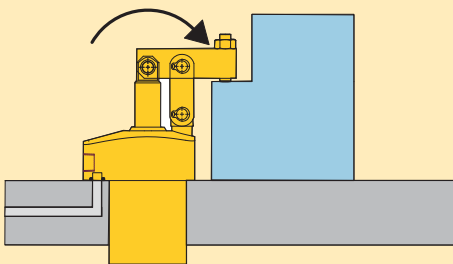

## Quick and accurate clamping action

- 70 bar operating pressure compatible with machine supplied pressure
- Design provides repeatable clamping location
- Mounting flange feature BSPP and manifold ports
- Models available for Center, Right or Left Arm position
- Base features an electroless nickel plating for corrosion resistance and durability

### ▼ PRODUCT SELECTION

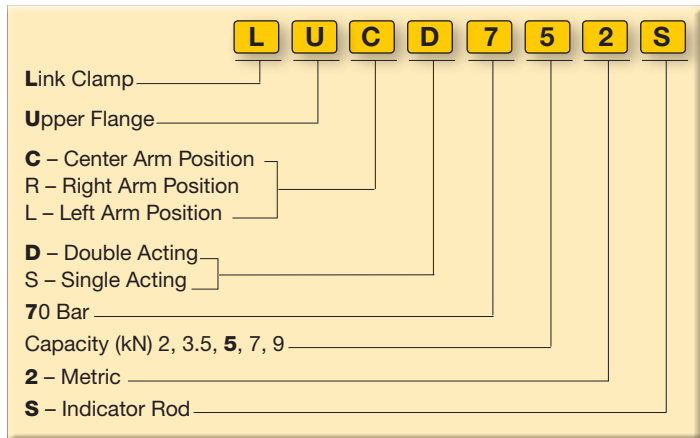

### Product selection

Clamping force	Stroke	Model number	Cylinder effective area	Oil capacity	Clamp arm (Sold separately)	
					Long	Standard
kN	mm		cm <sup>2</sup>	cm <sup>3</sup>		
<b>▼ Single acting</b>						
2	20,5	LUCS-722	4,2	8,5	LCAL-7232	LCAS-7232
3,5	20,5	LUCS-732	6,4	13,1	LCAL-7232	LCAS-7232
5	26,5	LUCS-752	9,6	25,5	LCAL-7572	LCAS-7572
7	26,5	LUCS-772	12,6	33,3	LCAL-7572	LCAS-7572
9	32,5	LUCS-792	15,9	51,7	LCAL-792	LCAS-792
<b>▼ Single acting with indicator staff</b>						
2	20,5	LUCS-722S	3,7	7,6	LCAL-7232	LCAS-7232
3,5	20,5	LUCS-732S	5,9	12,1	LCAL-7232	LCAS-7232
5	26,5	LUCS-752S	9,1	24,1	LCAL-7572	LCAS-7572
7	26,5	LUCS-772S	12,1	32,1	LCAL-7572	LCAS-7572
9	32,5	LUCS-792S	15,4	50,1	LCAL-792	LCAS-792
<b>▼ Double acting</b>						
2	20,5	LUCD-722	4,2	8,5	LCAL-7232	LCAS-7232
3,5	20,5	LUCD-732	6,4	13,1	LCAL-7232	LCAS-7232
5	26,5	LUCD-752	9,6	25,5	LCAL-7572	LCAS-7572
7	26,5	LUCD-772	12,6	33,3	LCAL-7572	LCAS-7572
9	32,5	LUCD-792	15,9	51,7	LCAL-792	LCAS-792
<b>▼ Double acting with indicator staff</b>						
2	20,5	LUCD-722S	3,7	7,6	LCAL-7232	LCAS-7232
3,5	20,5	LUCD-732S	5,9	12,1	LCAL-7232	LCAS-7232
5	26,5	LUCD-752S	9,1	24,1	LCAL-7572	LCAS-7572
7	26,5	LUCD-772S	12,1	32,1	LCAL-7572	LCAS-7572
9	32,5	LUCD-792S	15,4	50,1	LCAL-792	LCAS-792



## Blank clamp arms for convenient fabrication of custom arms

- Short Arm includes contact bolt and lock nut
- Blank Long Arm can be customized to the length and configuration required
- LCAS-7232/LCAL-7232 used with both the 2 kN and the 3,5 kN Link Clamp Models
- LCAS-7572/LCAL-7572 used with both the 5 kN and the 7 kN Link Clamp Models
- LCAS-792/LCAL-792 used with the 9 kN Link Clamp Models

Clamp Force: 2-9 kN

Stroke: 20,5-32,5 mm

Pressure: 70 bar

**E** Cilindros amarre de enlace

**F** Bride basculante

**D** Gelenkspanner

### Options

A Long Arm is available for making custom arms.



### Important

Clamp arm should be parallel to cylinder mounting surface within 3° to avoid damage to cylinder and linkage.

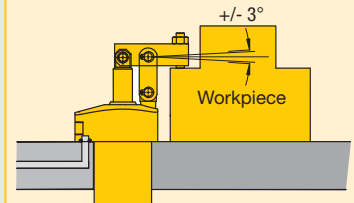

Models are available with Right Hand, Center and Left Hand arm position.

Left

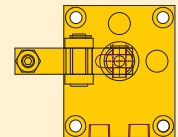

Center

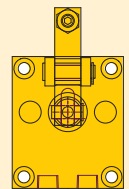

Right

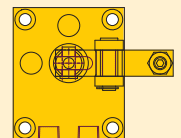

### LCAS models Standard Arm

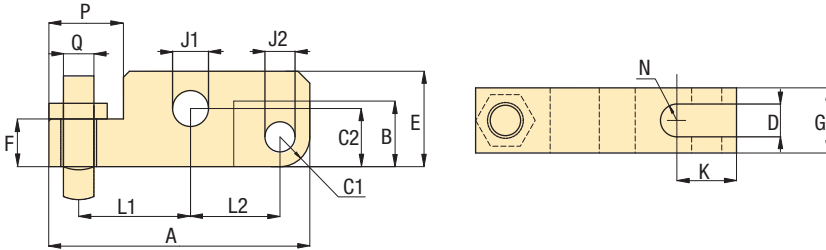

### Dimensions in mm [ ]

Clamp capacity kN	Model number	A	B	C1	C2	D	E	F	G
▼ Standard clamp arms									
2 & 3,5	LCAS-7232	54,0	13,0	6	9,5	6	16	8	11,85
5 & 7	LCAS-7572	74,5	17,5	8	15,5	10	25	13	18,85
9	LCAS-792	87,5	22,0	10	19,5	11	32	16	21,85

Clamp. capacity kN	Model number	J1	J2	K	L1	L2	N	P	Q
▼ Standard clamp arms									
2 & 3,5	LCAS-7232	6,02-6,07	6,02-6,07	13	23,5	18,5	3	13	M6 x 1,0
5 & 7	LCAS-7572	10,05-10,10	8,05-8,10	16	32,0	24,5	5	22	M10 x 1,5
9	LCAS-792	12,05-12,10	10,05-10,10	20	37,5	30,0	5,5	25	M12 x 1,75

### LCAL models Long Arm

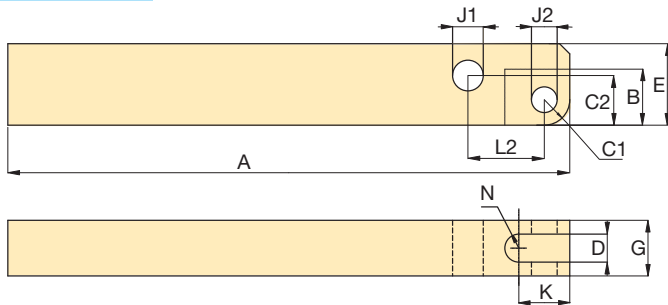

NOTE: Custom arms should be manufactured using this print. Make sure to follow all precautions listed.

### Dimensions in mm [ ]

Clamp. capacity kN	Model number	A	B	C1	C2	D	E	G	J1	J2	K	L2	N
▼ Long clamp arms													
2 & 3,5	LCAL-7232	85	13,0	6	9,50	6	16	11,85	6,02-6,07	6,02-6,07	13	18,5	3,0
5 & 7	LCAL-7572	105	17,5	8	15,50	10	25	18,85	10,05-10,10	8,05-8,10	16	24,5	5,0
9	LCAL-792	100	22,0	10	19,50	11	32	21,85	12,05-12,1	10,05-10,10	20	30,0	5,5

# 70 Bar Link Clamps, LU7 series

Shown: LUCD772



**▶ Link Clamp allows unobstructed part loading - extend to produce clamping force and retract to allow part removal.**

## ⚠ Important

Clamp point must be within the boundaries of the anchor links of the clamp. Clamping outside of this area will cause damage to the linkage, leading to premature failure.

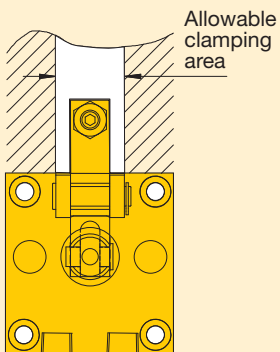

## Standard or custom built

- Use **LCAL** clamp arms to make custom length arms
- Make your own custom arm to suit your application

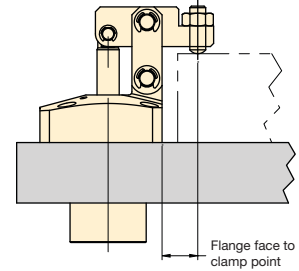

## 🌐 Pressure vs clamping force

Clamp arm length and operating pressure determine the clamping force.

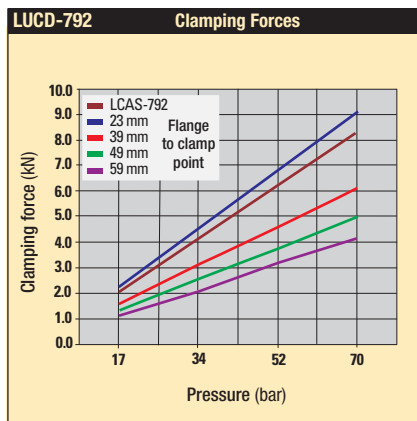
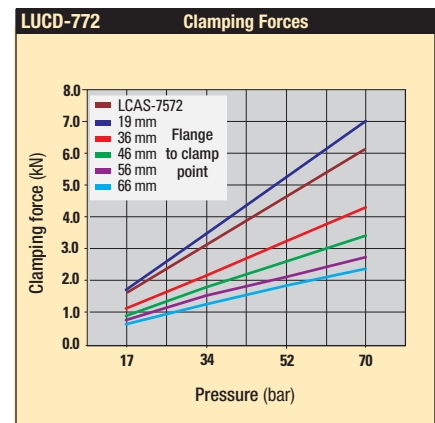
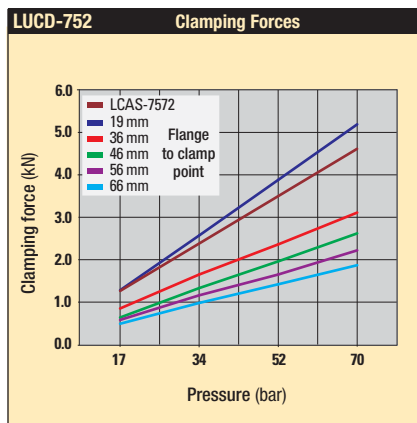
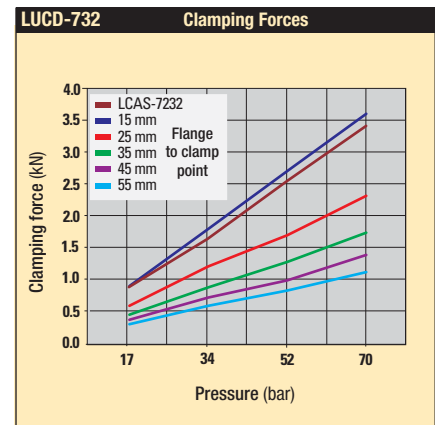
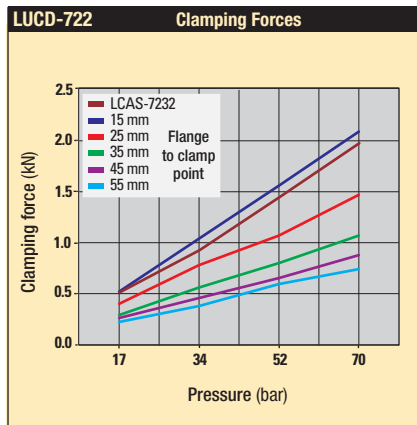



## Pressure vs clamping force

Clamp arm length and operating pressure determine the clamping force.

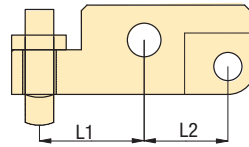

### \*LUCD-722

L-2 Dimension mm	L-1 Dimension mm	L-1 + L-2 Dimension mm	Flange Face to Clamp Point mm	Clamping Force (kN)			
				17 (bar)	34 (bar)	52 (bar)	70 (bar)
18,5	21,5	40	15	0,52	1,04	1,56	2,20
18,5	23,5	42	17**	0,53	0,98	1,42	1,91
18,5	31,5	50	25	0,40	0,78	1,07	1,47
18,5	41,5	60	35	0,29	0,56	0,80	1,07
18,5	51,5	70	45	0,24	0,44	0,64	0,87
18,5	61,5	80	55	0,20	0,36	0,58	0,73

\*\*LCAS-7232

### \*LUCD-732

L-2 Dimension (mm)	L-1 Dimension (mm)	L-1 + L-2 Dimension (mm)	Flange Face to Clamp Point (mm)	Clamping Force (kN)			
				17 (bar)	34 (bar)	52 (bar)	70 (bar)
18,5	21,5	40	15	0,89	1,79	2,70	3,60
18,5	23,5	42	17**	0,85	1,69	2,54	3,45
18,5	31,5	50	25	0,58	1,20	1,69	2,31
18,5	41,5	60	35	0,44	0,87	1,27	1,73
18,5	51,5	70	45	0,36	0,71	0,98	1,38
18,5	61,5	80	55	0,29	0,58	0,82	1,11

\*\*LCAS-7232

### \*LUCD-752

L-2 Dimension (mm)	L-1 Dimension (mm)	L-1 + L-2 Dimension (mm)	Flange Face to Clamp Point (mm)	Clamping Force (kN)			
				17 (bar)	34 (bar)	52 (bar)	70 (bar)
24,5	28,5	53	19	1,28	2,57	3,88	5,19
24,5	32,0	56,5	22,5**	1,20	2,40	3,56	4,63
24,5	45,5	70	36	0,85	1,65	2,36	3,11
24,5	55,5	80	46	0,64	1,33	1,96	2,62
24,5	65,5	90	56	0,58	1,16	1,65	2,22
24,5	75,5	100	66	0,49	0,98	1,42	1,87

\*\*LCAS-7572

### \*LUCD-772

L-2 Dimension (mm)	L-1 Dimension (mm)	L-1 + L-2 Dimension (mm)	Flange Face to Clamp Point (mm)	Clamping Force (kN)			
				17 (bar)	34 (bar)	52 (bar)	70 (bar)
24,5	28,5	53	19	1,74	3,48	5,24	7,00
24,5	32,0	56,5	22,5**	1,65	3,16	4,72	6,18
24,5	45,5	70	36	1,16	2,18	3,25	4,31
24,5	55,5	80	46	0,93	1,82	2,62	3,43
24,5	65,5	90	56	0,80	1,56	2,14	2,76
24,5	75,5	100	66	0,67	1,29	1,87	2,40

\*\*LCAS-7572

### \*LUCD-792

L-2 Dimension (mm)	L-1 Dimension (mm)	L-1 + L-2 Dimension (mm)	Flange Face to Clamp Point (mm)	Clamping Force (kN)			
				17 (bar)	34 (bar)	52 (bar)	70 (bar)
30,0	34,0	64	23	2,26	4,52	6,81	9,10
30,0	37,5	67,5	26,5**	2,09	4,18	6,23	8,32
30,0	50,0	80	39	1,56	3,07	4,54	6,05
30,0	60,0	90	49	1,25	2,49	3,69	4,94
30,0	70,0	100	59	1,07	2,05	3,11	4,14

\*\*LCAS-792

\*Note: L-1 is the length from the clamp point to the centerline of the pin in the pivot lug. L-2 is the length from the centerline of the cylinder plunger to the centerline of the pin in the pivot lug. © 2011

Clamp Force: 2-9 kN

Stroke: 20,5-32,5 mm

Pressure: 70 bar

**E** Cilindros amarre de enlace

**F** Bride basculante

**D** Gelenkspanner

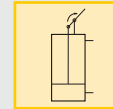
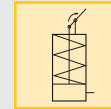

## Options

Long clamp arms

3 ▶



## Important

Clamp arm should be parallel to cylinder mounting surface within 3° to avoid damage to cylinder and linkage. Use the included set screw to adjust clamp arm alignment.

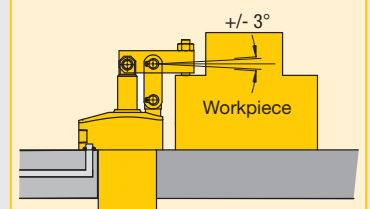

# 70 Bar Link clamps, LU7 series

Shown: LUCD772



▶ Link Clamp allows unobstructed part loading - extend to produce clamping force and retract to allow part removal.

## Standard or custom built

- Use **LCAL** clamp arms to make custom length arms
- Make your own custom arm to suit your application

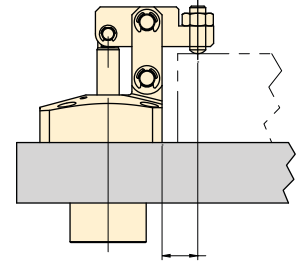

## Pressure vs clamping force

Clamp arm length and operating pressure determine the clamping force.

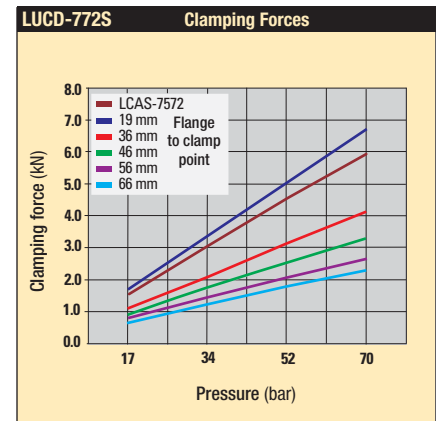
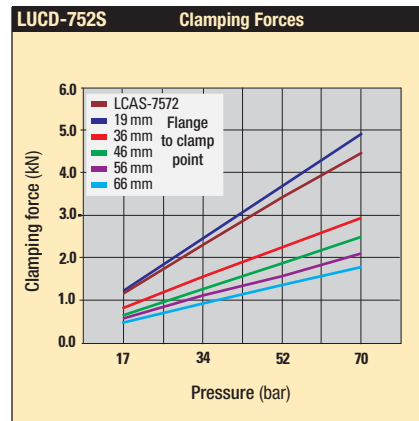
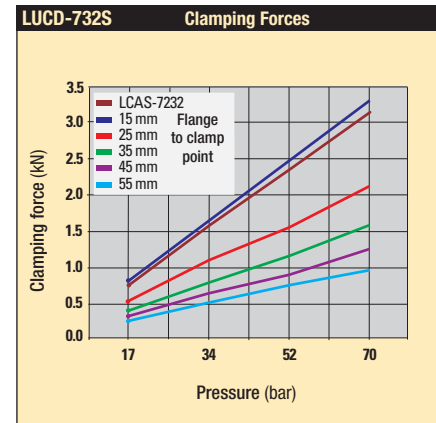
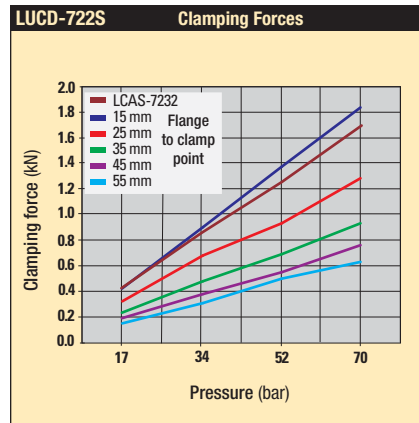

## ⚠ Important

The Clamping Force developed by a Link Clamp is a function of both the operating pressure and the arm length. The charted capacities are based on the distance from the front of the cylinder flange to the clamping point on the arm.

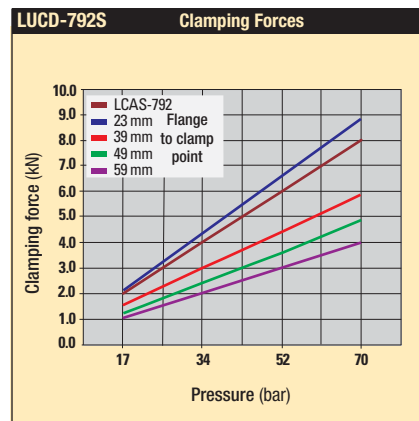

## Pressure vs clamping force

Clamp arm length and operating pressure determine the clamping force.

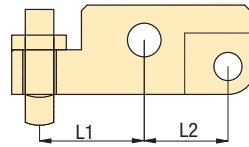

### \*LUCD-722S

L-2 Dimension mm	L-1 Dimension mm	L-1 + L-2 Dimension mm	Flange Face to Clamp Point (mm)	Clamping Force (kN)			
				17 (bar)	34 (bar)	52 (bar)	70 (bar)
18,5	21,5	40	15	0,45	0,91	1,38	1,84
18,5	23,5	42	17**	0,47	0,87	1,25	1,67
18,5	31,5	50	25	0,35	0,69	0,94	1,29
18,5	41,5	60	35	0,25	0,49	0,70	0,94
18,5	51,5	70	45	0,21	0,39	0,56	0,77
18,5	61,5	80	55	0,17	0,32	0,51	0,64

\*\*LCAS-7232

### \*LUCD-732S

L-2 Dimension (mm)	L-1 Dimension (mm)	L-1 + L-2 Dimension (mm)	Flange Face to Clamp Point (mm)	Clamping Force (kN)			
				17 (bar)	34 (bar)	52 (bar)	70 (bar)
18,5	21,5	40	15	0,82	1,65	2,48	3,30
18,5	23,5	42	17**	0,78	1,56	2,34	3,16
18,5	31,5	50	25	0,53	1,11	1,56	2,13
18,5	41,5	60	35	0,41	0,80	1,17	1,59
18,5	51,5	70	45	0,33	0,65	0,90	1,27
18,5	61,5	80	55	0,27	0,53	0,76	0,97

\*\*LCAS-7232

### \*LUCD-752S

L-2 Dimension (mm)	L-1 Dimension (mm)	L-1 + L-2 Dimension (mm)	Flange Face to Clamp Point (mm)	Clamping Force (kN)			
				17 (bar)	34 (bar)	52 (bar)	70 (bar)
24,5	28,5	53,0	19,0	1,22	2,45	3,68	4,92
24,5	32,0	56,5	22,5**	1,13	2,29	3,38	4,38
24,5	45,5	70,0	36,0	0,81	1,56	2,24	2,94
24,5	55,5	80,0	46,0	0,61	1,26	1,86	2,48
24,5	65,5	90,0	56,0	0,55	1,10	1,56	2,10
24,5	75,5	100,0	66,0	0,46	0,93	1,35	1,77

\*\*LCAS-7572

### \*LUCD-772S

L-2 Dimension (mm)	L-1 Dimension (mm)	L-1 + L-2 Dimension (mm)	Flange Face to Clamp Point (mm)	Clamping Force (kN)			
				17 (bar)	34 (bar)	52 (bar)	70 (bar)
24,5	28,5	53,0	19,0	1,67	3,35	5,04	6,72
24,5	32,0	56,0	22,5**	1,58	3,05	4,54	5,94
24,5	45,5	70,0	36,0	1,11	2,09	3,12	4,14
24,5	55,5	80,0	46,0	0,89	1,75	2,52	3,29
24,5	65,5	90,0	56,0	0,77	1,50	2,05	2,65
24,5	75,5	100,0	66,0	0,64	1,24	1,80	2,30

\*\*LCAS-7572

### \*LUCD-792S

L-2 Dimension (mm)	L-1 Dimension (mm)	L-1 + L-2 Dimension (mm)	Flange Face to Clamp Point (mm)	Clamping Force (kN)			
				17 (bar)	34 (bar)	52 (bar)	70 (bar)
30,0	34,0	64,0	23,0	2,19	4,39	6,59	8,79
30,0	37,5	67,5	26,5**	2,02	4,05	6,05	8,05
30,0	50,0	80,0	39,0	1,51	2,97	4,40	5,86
30,0	60,0	90,0	49,0	1,20	2,41	3,57	4,78
30,0	70,0	100,0	59,0	1,04	1,99	3,01	4,00

\*\*LCAS-792

\*Note: L-1 is the length from the clamp point to the centerline of the pin in the pivot lug. L-2 is the length from the centerline of the cylinder plunger to the centerline of the pin in the pivot lug. © 2011

Clamp Force: 2-9 kN
Stroke: 20,5-32,5 mm
Pressure: 70 bar

- E** Cilindros amarre de enlace
- F** Bride basculante
- D** Gelenkspanner

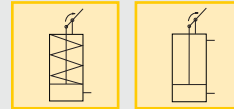

## Options

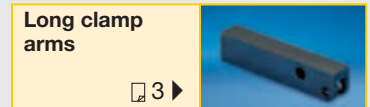

## Important

Clamp arm should be parallel to cylinder mounting surface within 3° to avoid damage to cylinder and linkage. Use the included set screw to adjust clamp arm alignment.

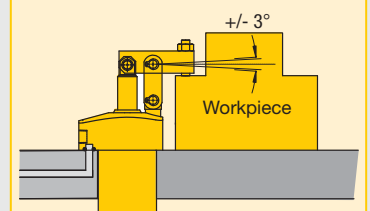

# 70 Bar Link clamps, LU7 series

Shown: LUCD772



**▶ Link Clamp allows unobstructed part loading - extend to produce clamping force and retract to allow part removal.**

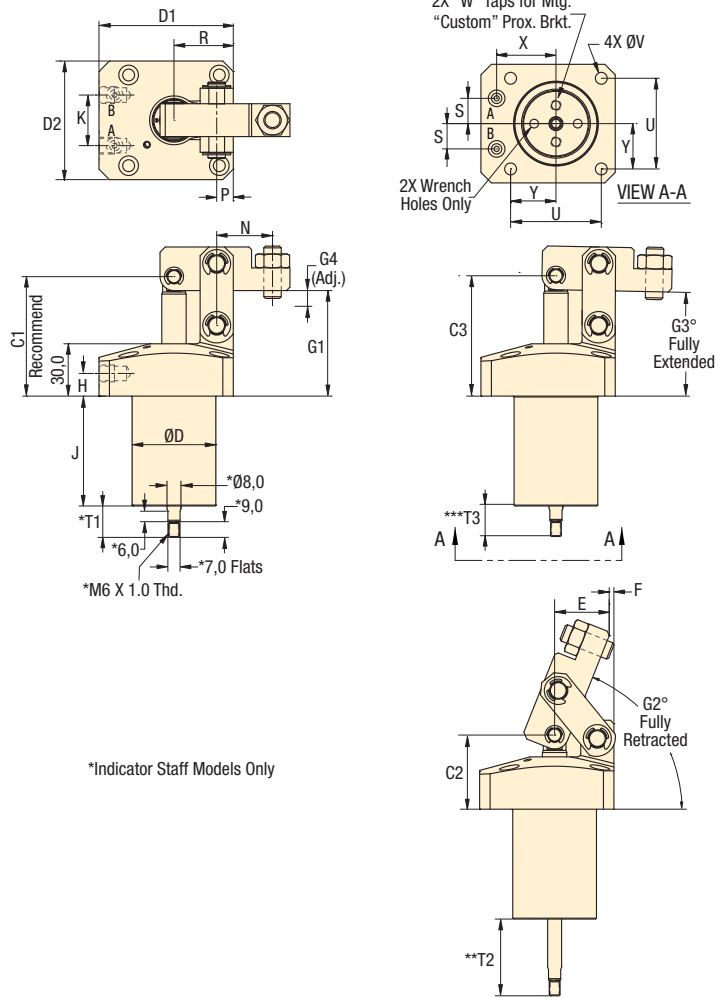

\*Indicator Staff Models Only

## **A** Dimensions in mm

Model Number	Port Size	C1 standard	C2 max.	C3	D Ø	D1	D2	E	F	G1	G2°	G3°	G4
<b>▼ Single acting</b>													
LUCS-722	G1/8"	59.5	39.5	60.0	36.0	60.0	50.0	21.8	3.2	53.5	69.4	1.5	7.0
LUCS-732	G1/8"	59.5	39.5	60.0	42.0	60.0	50.0	21.8	3.2	53.5	69.4	1.5	7.0
LUCS-752	G1/8"	68.5	42.5	69.0	48.0	77.0	68.0	31.3	2.7	60.5	68.3	1.2	9.0
LUCS-772	G1/8"	68.5	42.5	69.0	54.0	77.0	68.0	31.3	2.7	60.5	68.3	1.2	9.0
LUCS-792	G1/4"	79.0	48.5	81.0	60.0	96.0	82.0	39.9	1.1	69.0	66.0	2.0	9.0
<b>▼ Single-acting with Staff</b>													
LUCS-722S	G1/8"	59.5	39.5	60.0	36.0	60.0	50.0	21.8	3.2	53.5	69.4	1.5	7.0
LUCS-732S	G 1/8"	59.5	39.5	60.0	42.0	60.0	50.0	21.8	3.2	53.5	69.4	1.5	7.0
LUCS-752S	G 1/8"	68.5	42.5	69.0	48.0	77.0	68.0	31.3	2.7	60.5	68.3	1.2	9.0
LUCS-772S	G 1/8"	68.5	42.5	69.0	54.0	77.0	68.0	31.3	2.7	60.5	68.3	1.2	9.0
LUCS-792S	G 1/4"	79.0	48.5	81.0	60.0	96.0	82.0	39.9	1.1	69.0	66.0	2.0	9.0
<b>▼ Double acting</b>													
LUCD-722	G1/8"	59.5	39.5	60.0	36.0	60.0	50.0	21.8	3.2	53.5	69.4	1.5	7.0
LUCD-732	G 1/8"	59.5	39.5	60.0	42.0	60.0	50.0	21.8	3.2	53.5	69.4	1.5	7.0
LUCD-752	G 1/8"	68.5	42.5	69.0	48.0	77.0	68.0	31.3	2.7	60.5	68.3	1.2	9.0
LUCD-772	G 1/8"	68.5	42.5	69.0	54.0	77.0	68.0	31.3	2.7	60.5	68.3	1.2	9.0
LUCD-792	G 1/4"	79.0	48.5	81.0	60.0	96.0	82.0	39.9	1.1	69.0	66.0	2.0	9.0
<b>▼ Double-acting with Staff</b>													
LUCD-722S	G1/8"	59.5	39.5	60.0	36.0	60.0	50.0	21.8	3.2	53.5	69.4	1.5	7.0
LUCD-732S	G 1/8"	59.5	39.5	60.0	42.0	60.0	50.0	21.8	3.2	53.5	69.4	1.5	7.0
LUCD-752S	G 1/8"	68.5	42.5	69.0	48.0	77.0	68.0	31.3	2.7	60.5	68.3	1.2	9.0
LUCD-772S	G 1/8"	68.5	42.5	69.0	54.0	77.0	68.0	31.3	2.7	60.5	68.3	1.2	9.0
LUCD-792S	G 1/4"	79.0	48.5	81.0	60.0	96.0	82.0	39.9	1.1	69.0	66.0	2.0	9.0

\* Standard clamp position  
 \*\* Unclamped position  
 \*\*\* Maximum clamp position



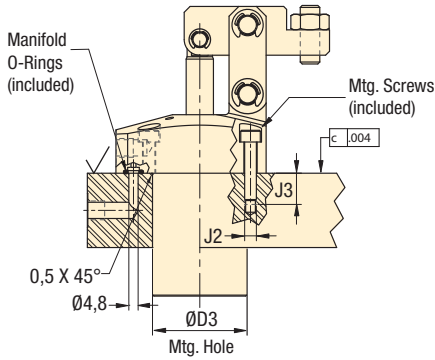

**A** Installation dimensions (mm)

Clamping force <sup>1)</sup> kN	Fixture hole Ø D3 mm	Mounting Bolts	Mounting Thread J2 mm	Minimum Depth J3 mm
2	36.5	M5 X 30	M5 X 0.8	12
3.5	42.5	M5 X 30	M5 X 0.8	12
5	48.5	M6 X 30	M6 X 1.0	16
7	54.5	M6 X 30	M6 X 1.0	16
9	60.5	M8 X 30	M8 X 1.25	18

<sup>1)</sup> With standard clamp arm.

**Note:** Mounting bolts and O-rings included.

- Clamp Force: 2-9 kN**
- Stroke: 20,5-32,5 mm**
- Pressure: 70 bar**

- E** Cilindros amarre de enlace
- F** Bride basculante
- D** Gelenkspanner

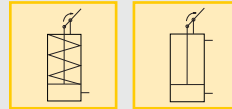

**D** Options

**Long clamp arms**

	H	J	K	N	P	R	S	*T1	*T2	*T3	U	V Ø	*W	X	Y	Wt. kgs	Model Number
<b>▼ Single acting</b>																	
	13.0	45.0	22.0	23.5	6.5	25.0	11.0	-	-	-	38.0	5.5	-	26.0	19.0	1,13	<b>LUCS-722</b>
	13.0	45.0	22.0	23.5	6.5	25.0	11.0	-	-	-	38.0	5.5	-	26.0	19.0	1,36	<b>LUCS-732</b>
	13.0	63.0	29.0	32.0	9.5	34.0	14.5	-	-	-	52.0	6.8	-	34.0	26.0	2,72	<b>LUCS-752</b>
	13.0	63.0	29.0	32.0	9.5	34.0	14.5	-	-	-	52.0	6.8	-	34.0	26.0	3,63	<b>LUCS-772</b>
	14.0	79.0	36.0	37.5	11.0	41.0	18.0	-	-	-	64.0	8.2	-	42.0	32.0	4,54	<b>LUCS-792</b>
<b>▼ Single-acting with Staff</b>																	
	13.0	45.0	22.0	23.5	6.5	25.0	11.0	18.0	38.0	17.5	38.0	5.5	M4 X 0.7 X 7.0 DP.	26.0	19.0	1,15	<b>LUCS-722S</b>
	13.0	45.0	22.0	23.5	6.5	25.0	11.0	18.0	38.0	17.5	38.0	5.5	M4 X 0.7 X 7.0 DP.	26.0	19.0	1,38	<b>LUCS-732S</b>
	13.0	63.0	29.0	32.0	9.5	34.0	14.5	18.0	44.0	17.5	52.0	6.8	M6 X 1.0 X 9.0 DP.	34.0	26.0	2,74	<b>LUCS-752S</b>
	13.0	63.0	29.0	32.0	9.5	34.0	14.5	18.0	44.0	17.5	52.0	6.8	M6 X 1.0 X 9.0 DP.	34.0	26.0	3,65	<b>LUCS-772S</b>
	14.0	79.0	36.0	37.5	11.0	41.0	18.0	19.5	50.0	17.5	64.0	8.2	M6 X 1.0 X 9.0 DP.	42.0	32.0	4,57	<b>LUCS-792S</b>
<b>▼ Double acting</b>																	
	13.0	45.0	22.0	23.5	6.5	25.0	11.0	-	-	-	38.0	5.5	-	26.0	19.0	1,13	<b>LUCD-722</b>
	13.0	45.0	22.0	23.5	6.5	25.0	11.0	-	-	-	38.0	5.5	-	26.0	19.0	1,36	<b>LUCD-732</b>
	13.0	63.0	29.0	32.0	9.5	34.0	14.5	-	-	-	52.0	6.8	-	34.0	26.0	2,72	<b>LUCD-752</b>
	13.0	63.0	29.0	32.0	9.5	34.0	14.5	-	-	-	52.0	6.8	-	34.0	26.0	3,63	<b>LUCD-772</b>
	14.0	79.0	36.0	37.5	11.0	41.0	18.0	-	-	-	64.0	8.2	-	42.0	32.0	4,54	<b>LUCD-792</b>
<b>▼ Double-acting with Staff</b>																	
	13.0	45.0	22.0	23.5	6.5	25.0	11.0	18.0	38.0	17.5	38.0	5.5	M4 X 0.7 X 7.0 DP.	26.0	19.0	1,15	<b>LUCD-722S</b>
	13.0	45.0	22.0	23.5	6.5	25.0	11.0	18.0	38.0	17.5	38.0	5.5	M4 X 0.7 X 7.0 DP.	26.0	19.0	1,38	<b>LUCD-732S</b>
	13.0	63.0	29.0	32.0	9.5	34.0	14.5	18.0	44.0	17.5	52.0	6.8	M6 X 1.0 X 9.0 DP.	34.0	26.0	2,74	<b>LUCD-752S</b>
	13.0	63.0	29.0	32.0	9.5	34.0	14.5	18.0	44.0	17.5	52.0	6.8	M6 X 1.0 X 9.0 DP.	34.0	26.0	3,65	<b>LUCD-772S</b>
	14.0	79.0	36.0	37.5	11.0	41.0	18.0	19.5	50.0	17.5	64.0	8.2	M6 X 1.0 X 9.0 DP.	42.0	32.0	4,57	<b>LUCD-792S</b>

\* Standard clamp position  
 \*\* Unclamped position  
 \*\*\* Maximum clamp position

# 70 Bar Link clamps, LU7 series

Shown: LUCD772



**▶ Link Clamp allows unobstructed part loading - extend to produce clamping force and retract to allow part removal.**

## Installation dimensions (mm)

### 2 kN Mounting Pattern

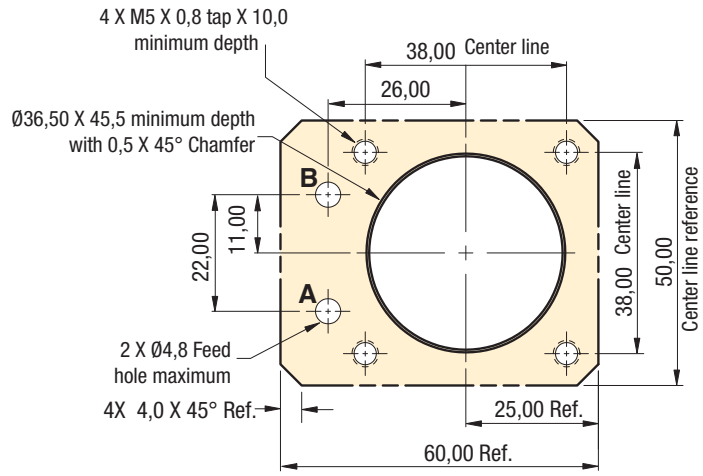

### 3,5 kN Mounting Pattern

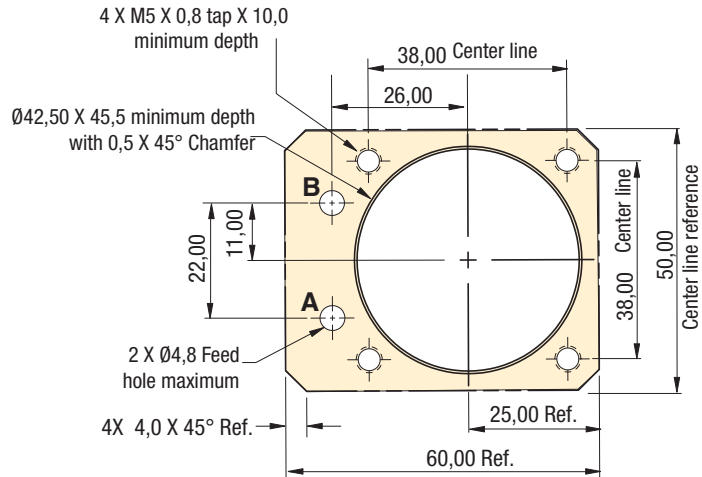

### 5 kN Mounting Pattern

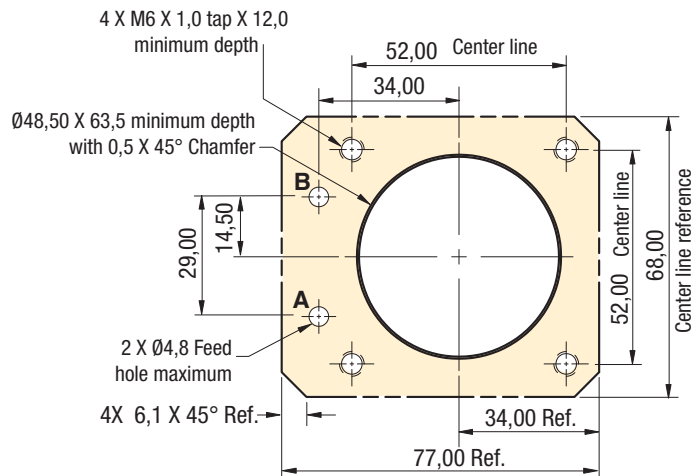



**Installation dimensions (mm)**

**7 kN Mounting Pattern**

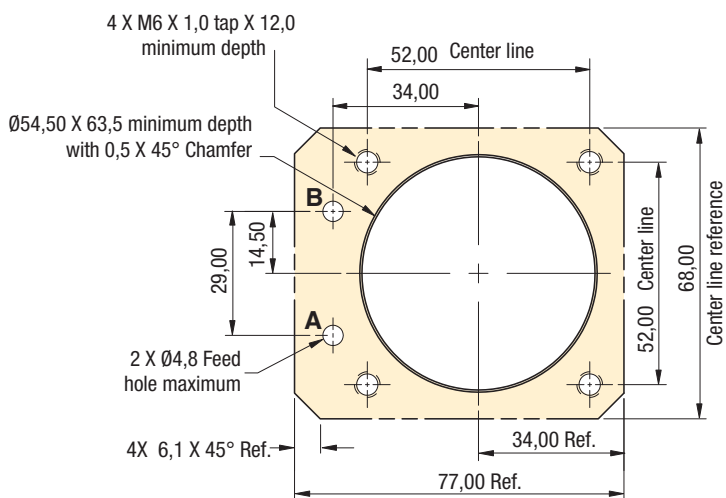

**9 kN Mounting Pattern**

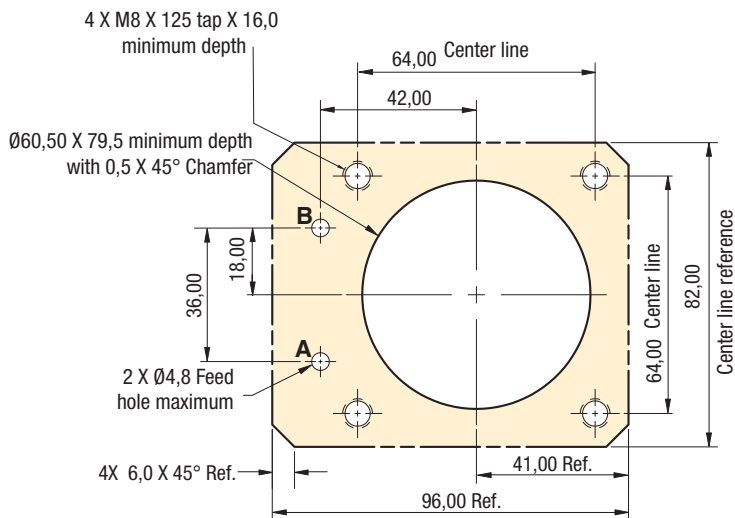

- Clamp Force: 2-9 kN
- Stroke: 20,5-32,5 mm
- Pressure: 70 bar

- E** Cilindros amarre de enlace
- F** Bride basculante
- D** Gelenkspanner

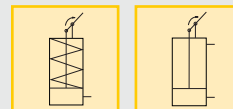

**Options**

Long clamp arms



For mounting pattern CAD files go to: [enerpacwh.com](http://enerpacwh.com)

# 70 Bar Link Clamp



## The Full Enerpac Workholding Line

### Cylinders

- Swing
- Link
- Pull
- Block
- Threaded Body
- Manifold Mount
- Work Supports
- Universal
- Hollow Plunger
- Positive Locking
- Pull Down
- Collet-Lok™

### Power Sources

- Air/Oil Boosters
- Turbo Air Driven
- Electric Pumps
- Hand Pumps
- Hydraulic Intensifiers
- Wand and Booster
- Screw Pump

### Valves

- Manual
- Solenoid
- Sequence
- Pilot Operated Check
- Flow Control
- Pressure Reducing

### System Components

- Accumulators
- Accumulator Pallet Units
- Auto Coupler Systems
- Rotary Couplers
- Gauges
- Fittings
- Tubing
- Manifolds
- Hoses
- Couplers
- AutoCouplers
- Pressure Switches
- Wireless Pressure Monitoring

### CAD Files

- Available at [www.enerpac.com](http://www.enerpac.com)

### Application Assistance

- Contact Enerpac at 1-414-747-8315



See the Enerpac Workholding Catalog for information about other Enerpac products.



See the Enerpac Industrial Tools Catalog for information about other Enerpac high-force tools.

## Enerpac Worldwide Locations

### Australia and New Zealand

Actuant Australia Ltd.  
Block V Unit 3  
Regents Park Estate  
391 Park Road  
Regents Park NSW 2143  
(P.O. Box 261) Australia  
T +61 297 438 988  
F +61 297 438 648  
[sales-au@enerpac.com](mailto:sales-au@enerpac.com)

### Brazil

Power Packer do Brasil Ltda.  
Rua dos Inocentes, 587  
04764-050 - Sao Paulo (SP)  
T +55 11 5687 2211  
F +55 11 5686 5583  
Toll Free: 0800 891 5770  
[vendasbrasil@enerpac.com](mailto:vendasbrasil@enerpac.com)

### Canada

Actuant Canada Corporation  
6615 Ordan Drive, Unit 14-15  
Mississauga, Ontario  
L5T 1X2  
T +1 905 564 5749  
F +1 905 564 0305  
Toll Free:  
T +1 800 268 4987  
F +1 800 461 2456  
[customer.service@actuant.com](mailto:customer.service@actuant.com)

### China

Actuant (China) Industries Co. Ltd.  
No. 6 Nanjing East Road  
Taicang Economic Dep Zone  
Jiangsu, China  
T +86 0512 5328 7500  
F +86 0512 5335 9690  
[marketingchina@enerpac.com](mailto:marketingchina@enerpac.com)

### France, Switzerland, North Africa and French speaking African countries

ENERPAC  
Une division d'ACTUANT  
France S.A.S.  
ZA de Courtaoef  
32, avenue de la Baltique  
91140 VILLEBON /YVETTE  
France  
T +33 1 60 13 68 68  
F +33 1 69 20 37 50  
[sales-fr@enerpac.com](mailto:sales-fr@enerpac.com)

### Germany and Austria

ENERPAC GmbH  
P.O. Box 300113  
D-40401 Düsseldorf  
Willstätterstrasse 13  
D-40549 Düsseldorf, Germany  
T +49 211 471 490  
F +49 211 471 49 28  
[sales-de@enerpac.com](mailto:sales-de@enerpac.com)

### India

ENERPAC Hydraulics Pvt. Ltd.  
No. 1A, Peenya Industrial Area  
IInd Phase, Bangalore,  
560 058, India  
T +91 80 40 792 777  
F +91 80 40 792 792  
[sales-in@enerpac.com](mailto:sales-in@enerpac.com)

### Italy

ENERPAC S.p.A.  
Via Canova 4  
20094 Corsico (Milano)  
T +39 02 4861 111  
F +39 02 4860 1288  
[sales-it@enerpac.com](mailto:sales-it@enerpac.com)

### Japan

Applied Power Japan LTD KK  
Besshocho 85-7  
Kita-ku, Saitama-shi 331-0821, Japan  
T +81 48 662 4911  
F +81 48 662 4955  
[sales-jp@enerpac.com](mailto:sales-jp@enerpac.com)

### Middle East, Egypt & Libya

ENERPAC Middle East FZE  
Office 423, LOB 15  
P.O. Box 18004, Jebel Ali,  
Dubai  
United Arab Emirates  
T +971 (0)4 8872686  
F +971 (0)4 8872687  
[sales-ua@enerpac.com](mailto:sales-ua@enerpac.com)

### Russia

Rep. office Enerpac  
Russian Federation  
Admiral Makarova Street 8  
125212 Moscow, Russia  
T +7 495 98090 91  
F +7 495 98090 92  
[sales-ru@enerpac.com](mailto:sales-ru@enerpac.com)

### Singapore

Actuant Asia Pte Ltd.  
83 Joo Koon Circle  
Singapore 629109  
T +65 68 63 0611  
F +65 64 84 5669  
Toll Free: +1800 363 7722  
[sales-sg@enerpac.com](mailto:sales-sg@enerpac.com)

### South Korea

Actuant Korea Ltd.  
3Ba 717, Shihwa Industrial Complex  
Jungwang-Dong, Shihung-Shi,  
Kyunggi-Do  
Republic of Korea 429-450  
T +82 31 434 4506  
F +82 31 434 4507  
[sales-kr@enerpac.com](mailto:sales-kr@enerpac.com)

### Spain and Portugal

ENERPAC SPAIN, S.L.  
Avda. Los Frailes, 40 –  
Nave C & D  
Pol. Ind. Los Frailes  
28814 Daganzo de Arriba  
(Madrid) Spain  
T +34 91 884 86 06  
F +34 91 884 86 11  
[sales-es@enerpac.com](mailto:sales-es@enerpac.com)

### Sweden, Denmark, Norway, Finland and Iceland

Enerpac Scandinavia AB  
Fabriksgatan 7  
412 50 Gothenburg  
Sweden  
T +46 (0) 31 799 0281  
F +46 (0) 31 799 0010  
[scandinavianinquiries@enerpac.com](mailto:scandinavianinquiries@enerpac.com)

### The Netherlands, Belgium, Luxembourg, Central and Eastern Europe, Baltic States, Greece, Turkey and CIS countries

ENERPAC B.V.  
Galvanistraat 115  
6716 AE Ede  
P.O. Box 8097  
6710 AB Ede  
The Netherlands  
T +31 318 535 800  
F +31 318 535 848  
[sales-nl@enerpac.com](mailto:sales-nl@enerpac.com)

### Enerpac Integrated Solutions B.V.

Opaalstraat 44  
7554 TS Hengelo  
P.O. Box 421  
7550 AK Hengelo  
The Netherlands  
T +31 74 242 20 45  
F +31 74 243 03 38  
[integratedsolutions@enerpac.com](mailto:integratedsolutions@enerpac.com)

### South Africa and other English speaking African countries

ENERPAC B.V.  
Galvanistraat 115  
6716 AE Ede  
P.O. Box 8097  
6710 AB Ede  
The Netherlands  
T +31 318 535 911  
F +31 318 525 613  
[sales-za@enerpac.com](mailto:sales-za@enerpac.com)

### United Kingdom and Ireland

ENERPAC Ltd.,  
Bentley Road South  
Darlaston, West Midlands  
WS10 8LQ  
England  
T +44 (0)121 50 50 787  
F +44 (0)121 50 50 799  
[sales-uk@enerpac.com](mailto:sales-uk@enerpac.com)

### USA, Latin America and Caribbean

ENERPAC  
P.O. Box 3241  
Milwaukee  
WI 53201-3241 USA  
T +1 262 293 1500  
F +1 262 293 7036

### User inquiries:

+1 800 433 2766

Distributor inquiries/orders:

+1 800 558 0530

Technical inquiries:

[techservices@enerpac.com](mailto:techservices@enerpac.com)

[sales-us@enerpac.com](mailto:sales-us@enerpac.com)

e-mail: [info@enerpac.com](mailto:info@enerpac.com)

Internet: [www.enerpac.com](http://www.enerpac.com)