

Installation dimensions in mm

Clamp ¹⁾ force kN	Fixture hole Ø D3	Mounting thread J	Min. depth J2	Manifold O-ring ²⁾ ARP No. or Inside Ø x thickness
3	48,3	M6 x 1,0	16,5	-010
8	65,3	M8 x 1,0	19,0	-010
12	80,3	M8 x 1,0	19,0	-010
19	90,5	M10 x 1,25	22,5	-010
28	105,5	M12 x 1,25	24,0	-010

¹⁾ With standard clamp arm.

²⁾ Polyurethane, 92 Durometer

Note: Mounting bolts and O-rings included.

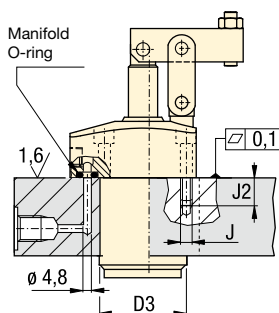

all models

Dimensions shown with standard clamp arm.

Double acting:

A = Clamp

B = Unclamp

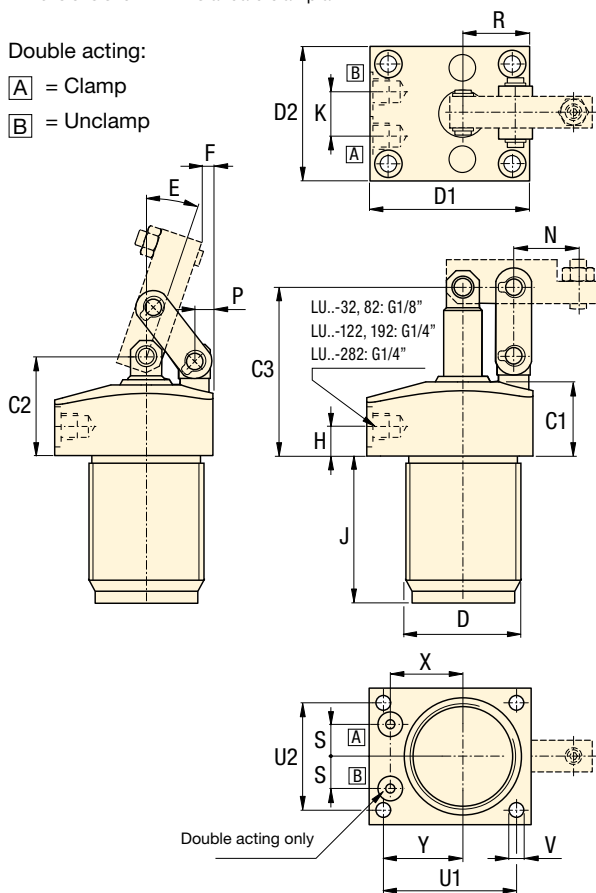

	F	H	J	K	N	P	R	S	U1	U2	V Ø	X	Y	kg
Single acting ▼														
1,0	10,9	47,0	-	23,6	8,4	27,9	10,4	52,1	46,0	6,6	28,7	29,0	1,2	
5,1	10,9	63,0	-	31,8	8,9	35,1	14,0	68,1	55,9	8,1	38,5	39,9	2,5	
0,8	11,9	71,1	-	37,6	11,9	43,9	16,1	87,9	73,9	8,1	44,2	51,1	4,5	
0,8	15,0	87,9	-	41,4	15,0	51,1	18,1	101,1	82,0	10,4	49,8	58,9	6,9	
2,0	20,1	99,1	-	51,1	16,0	59,9	20,9	115,1	100,1	13,0	57,3	65,0	11,7	
Double acting ▼														
1,0	10,9	47,0	20,1	23,6	8,4	27,9	21,6	52,1	46,0	6,6	20,5	29,0	1,2	
5,1	10,9	63,0	23,9	31,8	8,9	35,1	25,4	68,1	55,9	8,1	30,3	39,9	2,5	
0,8	11,9	71,1	30,0	37,6	11,9	43,9	26,4	87,9	73,9	8,1	37,7	51,1	5,0	
0,8	15,0	87,9	-	41,4	15,0	51,1	28,2	101,1	82,0	10,4	48,9	58,9	6,9	
2,0	20,1	99,1	38,1	51,1	16,0	59,9	30,0	115,1	100,1	13,0	52,0	65,0	11,7	

Clamp force: 2,9 - 28 kN

Stroke: 18,5 - 44,7 mm

Pressure: 35 - 350 bar

E Cilindros Amarre de enlace

F Bride basculante

D Gelenkspanner

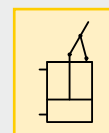
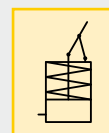

Options

Clamp arms

☐57▶



Work supports

☐43▶



Important

Single-acting cylinders use a regenerative circuit; oil is sent to both sides of the piston at the same time. This eliminates the breather port, reducing damage from coolant and contamination.

Clamp arm should be parallel to cylinder mounting surface within 3° to avoid damage to cylinder and linkage. Use the included set screw to adjust clamp arm alignment.